

OPERATOR'S MANUAL

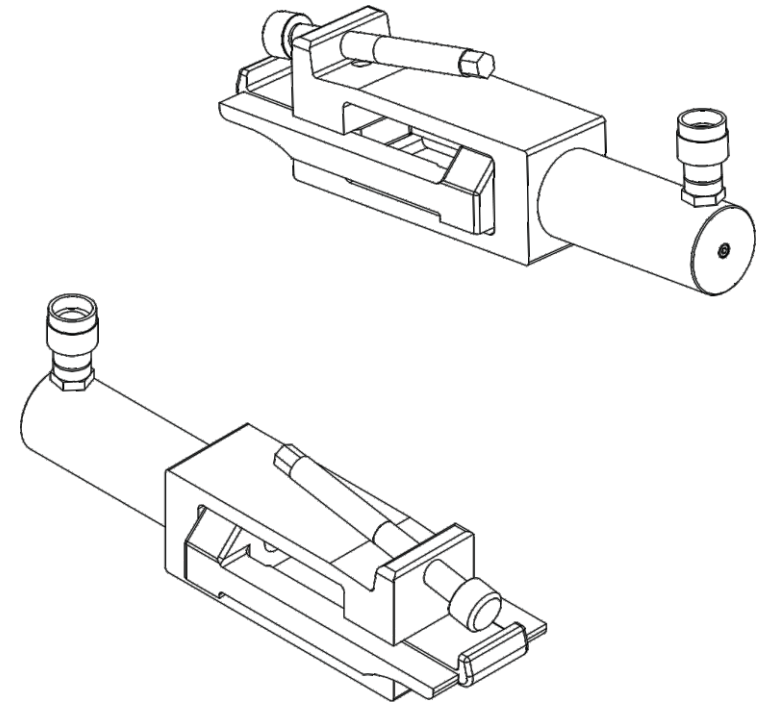

TIRE BEAD BREAKER

RESPONSIBILITY OF THE OWNER AND/OR THE END USER OF THIS DEVICE

This manual is an integral part of the BEAD BREAKER and must always accompany it, aslo in the case of its sale.

SAFETY INFORMATION

To avoid personal injury or property damage while using this product, read and follow all DANGERS, WARNINGS, CAUTIONS, and INSTRUCTIONS that are attached to, or included with, this product.

1. Follow the instructions of the tire manufacturer and the vehicle manufacturer when deflating, demounting, mounting, and inflating tires.
2. These operating instructions do not apply to any specific rim. Therefore, contact the rim manufacturer for the correct procedure for your rim.
3. We cannot be held responsible for damage or injury resulting from unsafe use of this product, lack of maintenance, or Incorrect product and system application.
4. Contact us when in doubt about safety precautions or applications.



WARNING

To avoid serious personal injury, always wear proper protective gear, such as hard hats, safety glasses, gloves, and steel toe shoes when using hydraulic equipment.

CAUTION

The bead breaker, and all tire tools, should be used only by persons properly trained.

OPERATING INSTRUCTIONS

REMOVING THE WHEEL

1. Chock the wheels opposite the jack
2. Jack up the vehicle
3. Crib the vehicle with safety stands or blocking devices after jacking it up.
Do not work under an unblocked load.

DANGER

Failure to chock the wheels and crib the vehicle can result in serious injury or death.

4. Remove the valve core; deflate tires completely.
5. Insert a thin piece of wire through the valve stem to make sure air is flowing freely and the valve stem is not blocked

NOTE: Deflate both tires if you have a dual mounting



DANGER

Always deflate tires before removing a wheel, a rim, or part of a rim or part of a rim, such as a rim clamp or nut. If you do not deflate the tire, the tire could explode, causing serious injury or death.

6a. If you are breaking the tire bead with the wheel off the vehicle: Proceed to Step 1 below, "Positioning the Bead Breaker"

6b. If you are breaking the tire bead with the wheel off the vehicle: Remove the tire/rim assembly from the vehicle and place it flat on the ground with the gutter side up. Then proceed to Step 1 below Positioning the Bead Breaker. "Positioning the Bead Breaker"

USING THE ND6200 BEAD BREAKERS Positioning the Bead Breaker

1. Place the bead breaker into the continuous pry bar pocket, with the hooks under the lip of the bead seat band.
2. Position the bead breaker so that it is about 30°, or at least 12 inches 0.3m, to one side of the flange butt weld.
3. Adjust the ram adjusting screw so that the bead breaker is perpendicular (90°) to the wheel.
4. Stand to one side of the bead breaker. Hold the bead breaker with one hand.

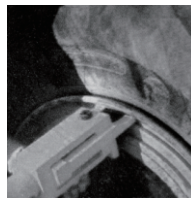

DANGER

Always stand to one side of the rim when using the bead breaker. Standing to one side of the bead breaker allows you to maintain control of the bead breaker. If it is not seated properly and flies off the rim, the bead breaker could cause serious injury or death.

Activating the Bead Breaker

CAUTION

The bead breaker uses a long stroke and high force. Be careful not to damage or bend rim parts, such as the flange butt weld, when using the bead breaker.

1. Turn on the hydraulic pump to activate the bead breaker
2. Apply enough hydraulic pressure to the bead breaker to push the lunge about 1/2-3/4 inch (13-19 mm) from the lip of the bead seat band.
3. If the bead breaker moves and is no longer vertical, readjust the ram adjusting screw. You must release pressure before adjusting the screw.
4. Continue applying hydraulic pressure until the flange is about 3/4 - 1 inch (19-25mm) from the lip of the bead seat band.
5. Place a nut or similar object between the flange and the lip of the bead seat band.

ATTENTION! SAFETY REGULATIONS

- a. Always deflate tires before starting disassembling operations
- b. Use the proper tools
- c. Always use protection means (accident-prevention shoes, etc. Do not forget that there are always crushing risks!
- d. Lock the safety rods on articulated vehicles
- e. Safety valve is set and sealed by the manufacturer. It is absolutely forbidden to tamper with it and change its calibration. The INCOMPLIANCE or these INSTRUCTIONS can cause damages and/or breakage to the BEA to persons and things.

Parts List

Index	Description	Q'ty	Index	Description	Q'ty
1	Toe body	1	12	Guide sleeve	1
2	Toe	1	13	Spring	1
3	Top cap	1	14	Ram piston	1
4	Snap ring	1	15	Cylinder	1
5	Screw	1	16	Coupler	1
6	Table pin	1	17	Screw	1
7	Bound ring	1	18	Ring	1
8	Toe housing	1	19	Ring	1
9	Screw	2	20	Y-ring	1
10	Pilot ring	2	21	Blade	1
11	Snap ring	2			

